

**AS BUILT**

**NOTES**

- All Dimensions in millimetres unless otherwise stated.
- Statutory Approval must be in place for all traffic signals and all traffic signal equipment supplied must be UK type approved.
- All work and equipment must be installed in accordance with the Statutory Approval and the Traffic Signal Design Standard (TSDS) 2015.
- Primary aspects on the same phase should be mounted at the same height above the road surface.
- Access observations are not to be installed in bus/parking areas.
- Creation of poles are normally 600mm minimum from kerbside and 500mm minimum from footway.
- Distance from pedestrian studs to stopline = 2m minimum.
- Distance between primary pole and stopline = 1m minimum.
- Distance between secondary pole and stopline = 1m minimum.
- Position of Workbox equipment to be confirmed following supplier survey.
- Workbox to be of presently safe design to specification 100LE or 100N.
- For details of Road Signs refer to drawings in Series 1200.
- Road markings are for traffic signal operation and compliance with the Traffic Signal Design Standard (TSDS) 2015.
- For details of kerbs, footways and paved areas refer to standard details in Series 1100.
- For details of Lanes refer to drawings in Series 1300.
- For details of pedestrian crossing refer to drawings in Series 400.
- For details of road markings refer to drawings in Series 1000.
- For details of road markings refer to drawings in Series 1000.
- This drawing should only be used for the Traffic Signal Design element stated in the title block.
- Dimensions of workbox to be confirmed following supplier survey.
- Dimensions of workbox to be confirmed following supplier survey.

**LEGEND**

- Primary Traffic Signal
- Secondary Traffic Signal
- Signal Head with Red and Green arrow aspect
- 600x600 Access Chamber
- 600x300 Loop Box
- 600x600 LRPC Ducting, Number of ducts marked
- Traffic Signal Controller
- Signal Disconnection and Termination Cabinet
- Termination Cabinet
- Magister
- Workbox access point
- MVD Detector
- Maintenance Hard Standing (see Note 17)
- Access Chamber
- Production Chamber (see note 20)
- Electrical Termination Point (see note 6)

Rev	As BUILT records updated	Redacted	Regulation	16/02/23	30/03/23	Date
1	As BUILT records updated	Redacted	Regulation	16/02/23	30/03/23	Date

**Project Name**  
 M8 M73 M74 MOTORWAY IMPROVEMENTS  
**Drawing Title**  
 TRAFFIC SIGNALS SECTION 1.3 SHAWHEAD CENTRAL TS DESIGN  
**Original Drawing Size** - A1  
**Dimensions** -  
**Scale** - 1:500  
**Copyright** © Amey  
**Drawing No**  
 CO21000101/1200/811  
**Rev**  
 A

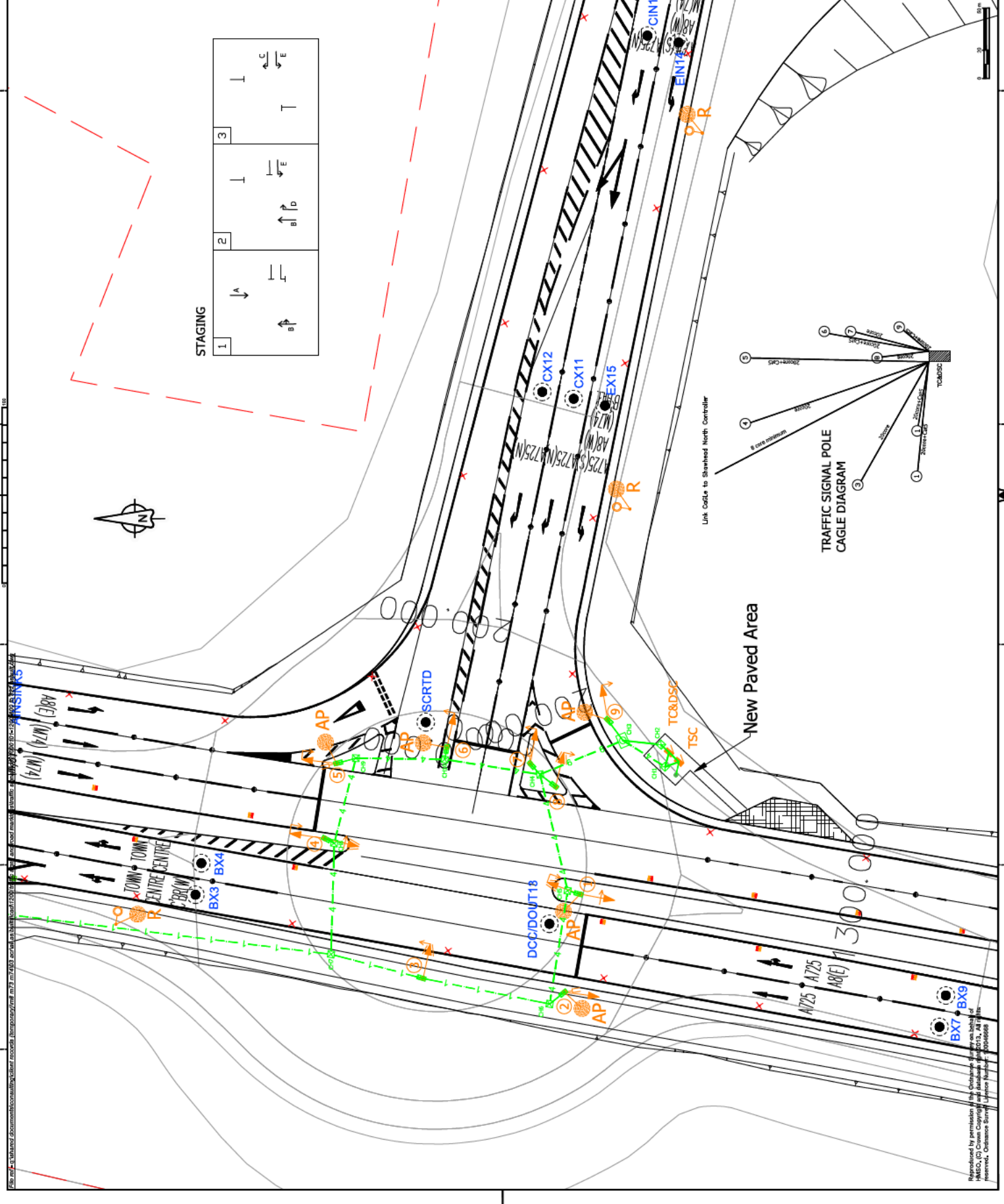

Reproduced by permission of the Ordnance Survey on behalf of HMRC. (C) Crown Copyright and database right 2013. All rights reserved. Ordnance Survey Licence Number: 100049888