



SASA
Roddinglaw Road
Edinburgh
EH12 9FJ

4th July 2017

Dear Sir/Madam,

SOIL TESTING FOR POTATO CYST NEMATODE (PCN)

FARM: WEST HERMISTON

CODE NO: 560/0025

FID NO: NT/16072/70416

Following an application of 21st June 2017, an official soil test for PCN conducted in accordance with paragraphs 1 to 6 of Schedule 15 of the Plant Health (Scotland) Order 2005 as amended by the Plant Health (Scotland) Amendment Order 2010 has been carried out on the sampled units requested on the above field. The results are set out below and the units sampled shown on the map overleaf. These results override any previously issued notices for the units sampled.

Sampled Unit	Area	Date of sampling	Result	<i>Globodera pallida</i>		<i>Globodera rostochiensis</i>	
				Infestation	Intensity	Infestation	Intensity
14244/A	0.1 Ha	23/06/2017	Clear	None	None	None	None
14244/B	0.1 Ha	23/06/2017	Clear	None	None	None	None
14244/C	0.1 Ha	23/06/2017	Clear	None	None	None	None
14244/D	0.1 Ha	23/06/2017	Clear	None	None	None	None
14244/E	0.1 Ha	23/06/2017	Clear	None	None	None	None
14244/F	0.1 Ha	23/06/2017	Clear	None	None	None	None
14244/G	0.1 Ha	23/06/2017	Clear	None	None	None	None
14244/H	0.1 Ha	23/06/2017	Clear	None	None	None	None
14244/I	0.1 Ha	23/06/2017	Clear	None	None	None	None
14244/J	0.1 Ha	23/06/2017	Clear	None	None	None	None
14244/K	0.1 Ha	23/06/2017	Clear	None	None	None	None
14244/L	0.1 Ha	23/06/2017	Clear	None	None	None	None
14244/M	0.1 Ha	23/06/2017	Clear	None	None	None	None
14244/N	0.1 Ha	23/06/2017	Clear	None	None	None	None
14244/O	0.1 Ha	23/06/2017	Clear	None	None	None	None
14244/P	0.1 Ha	23/06/2017	Clear	None	None	None	None
14244/Q	0.1 Ha	23/06/2017	Clear	None	None	None	None
14244/R	0.1 Ha	23/06/2017	Clear	None	None	None	None
14244/S	0.1 Ha	23/06/2017	Clear	None	None	None	None
14244/T	0.1 Ha	23/06/2017	Clear	None	None	None	None
14244/U	0.1 Ha	23/06/2017	Clear	None	None	None	None
14244/V	0.1 Ha	23/06/2017	Clear	None	None	None	None
14244/W	0.1 Ha	23/06/2017	Clear	None	None	None	None
14244/X	0.1 Ha	23/06/2017	Clear	None	None	None	None
14244/Y	0.1 Ha	23/06/2017	Clear	None	None	None	None
14244/Z	0.1 Ha	23/06/2017	Clear	None	None	None	None
14244/[0.1 Ha	23/06/2017	Clear	None	None	None	None

CLEARANCE FOR SEED POTATO PRODUCTION (INCLUDING FARM SAVED SEED)

VALID FOR SEASONS 2017 TO 2020

VALID FOR PB PRODUCTION 2017 TO 2020

For sampled units marked "Clear" in the table above, no viable PCN (*Globodera rostochiensis* or *Globodera pallida*) were found in the soil taken from that unit.

IMPORTANT

1. This clearance is valid for the period shown above, or until potatoes are planted in the land, whichever is earlier.
2. If produce from the specified sampled units is to be exported, the importing country may have special requirements in relation to PCN which are not met by this clearance.
3. This clearance may be withdrawn by SASA at any time if PCN are found in the sampled unit or

in soil or plant material connected with the sampled unit.

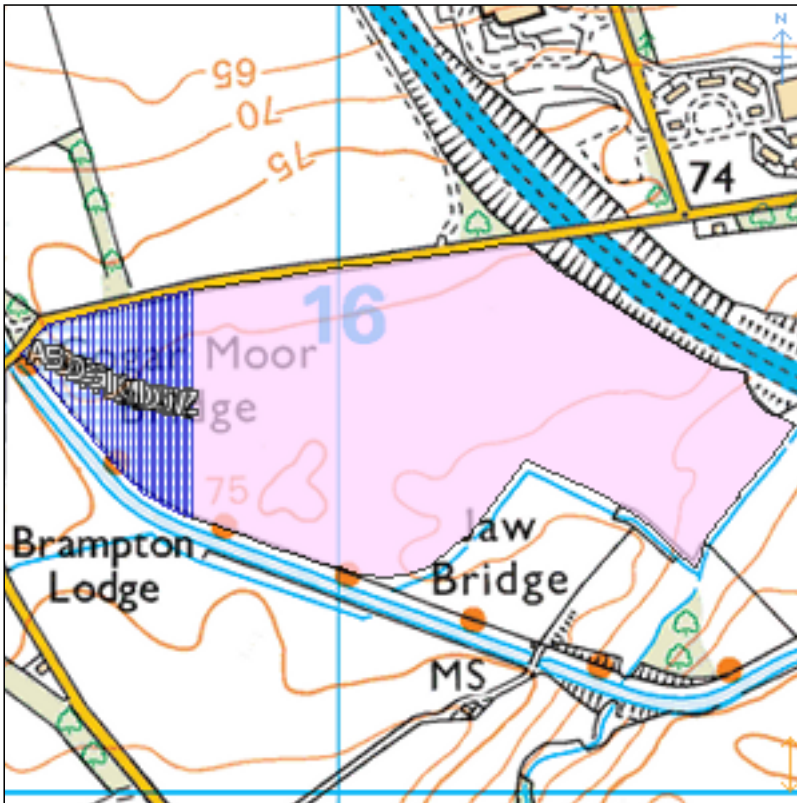

 **Clear**
 **Infested**



Soil Test: 14244

OS Base Layer reproduced by permission of Ordnance Survey on behalf of HMSO. © Crown copyright and database right 2017. All rights reserved. Ordnance Survey Licence number 100024655. © Crown copyright. All rights reserved Scottish Government 2017.

Please find maps with measurements for each individual sample unit appended to the end of this notification.

If you have any questions about these results, please contact me using the contact details given below.

Yours faithfully



SPCS Administration
T: 0131 244 8963
F: 0131 244 8920
E: @sasa.gsi.gov.uk

Sample Units (major grid: 100m, minor grid: 10m)

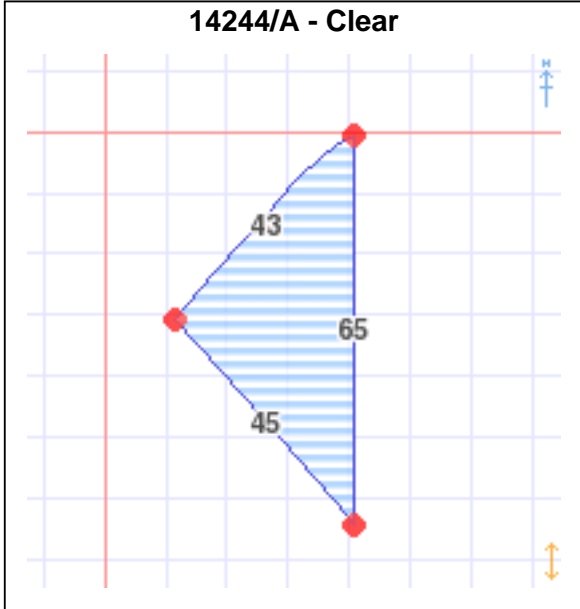
14244/A - Clear

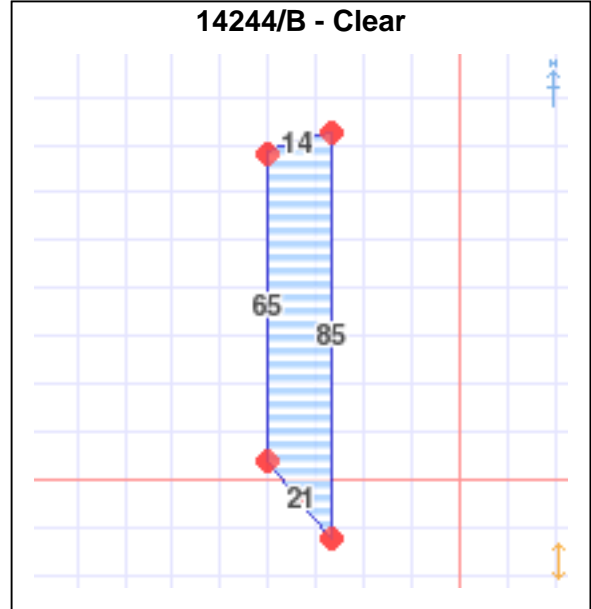

14244/B - Clear



14244/C - Clear

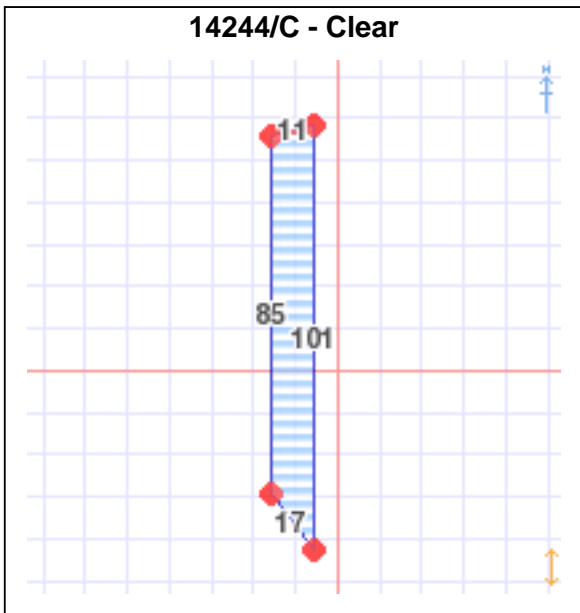

14244/D - Clear

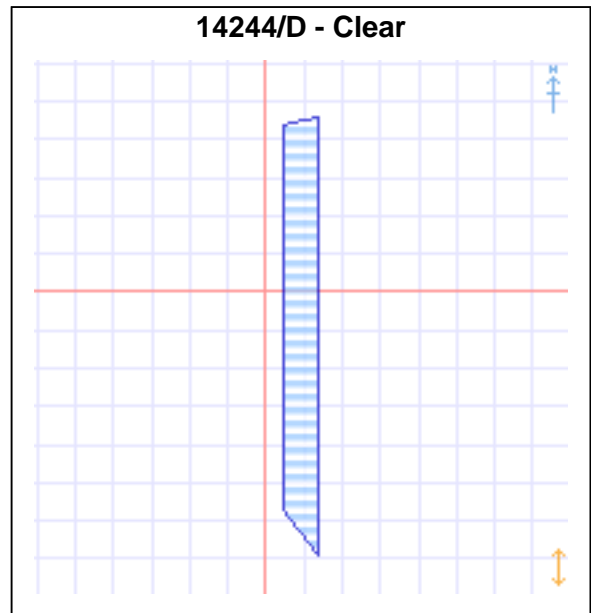

14244/E - Clear

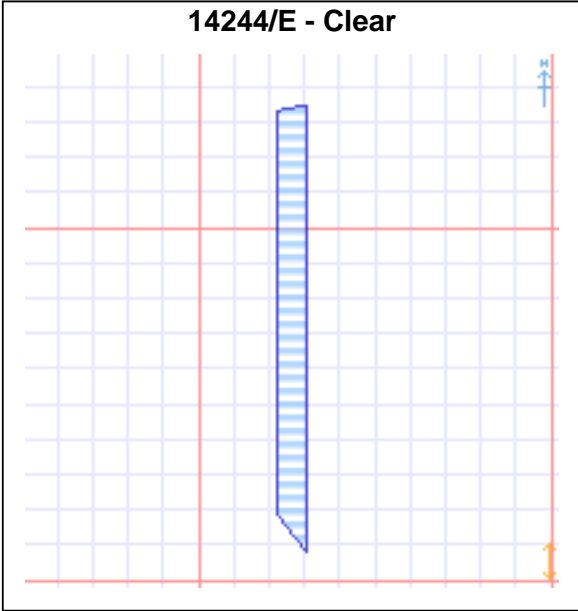

14244/F - Clear

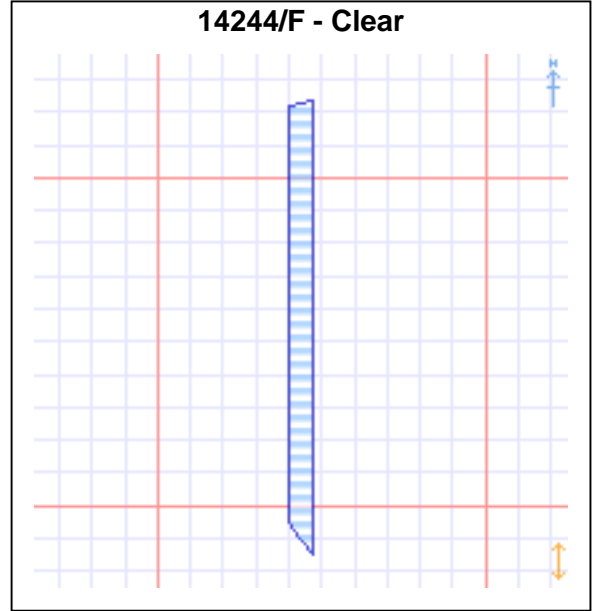

14244/G - Clear

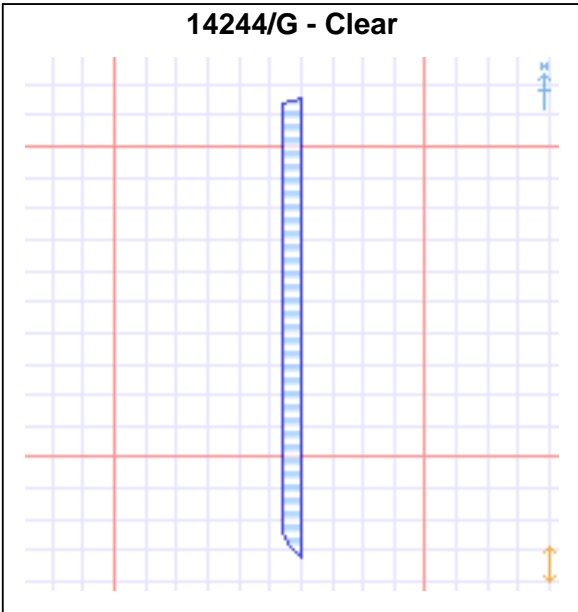

14244/H - Clear

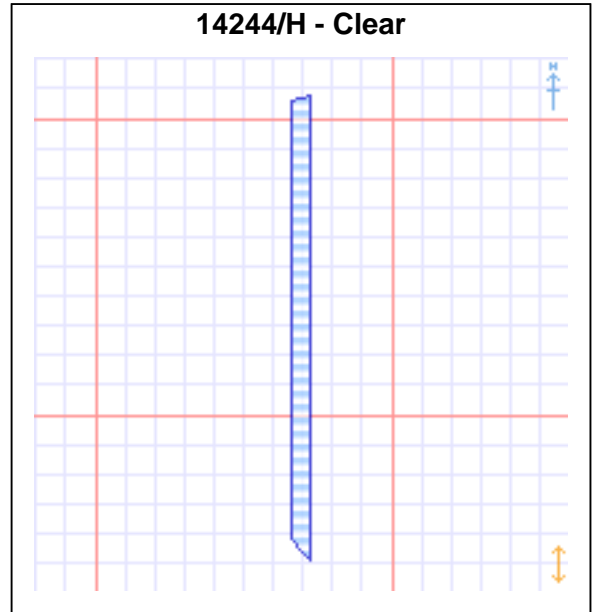

14244/I - Clear

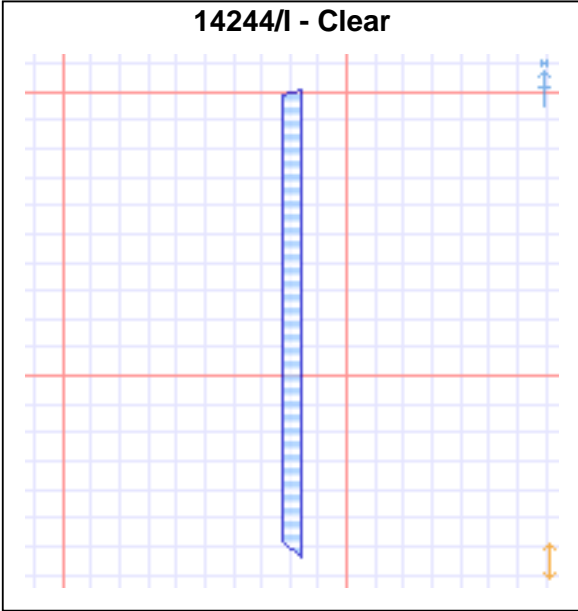

14244/J - Clear

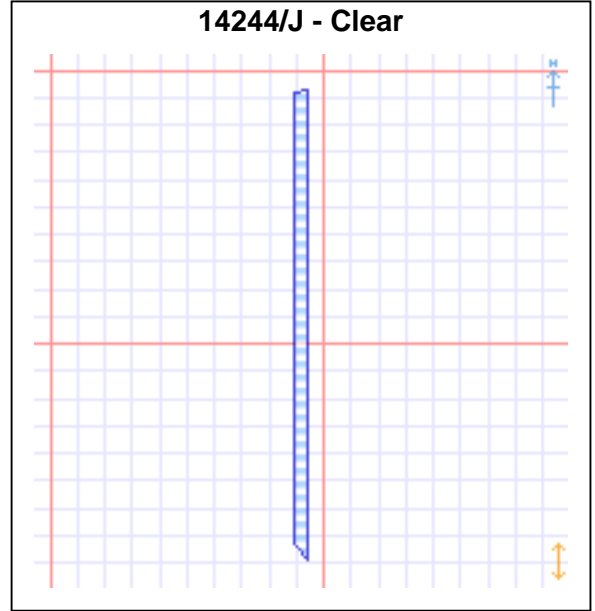

14244/K - Clear

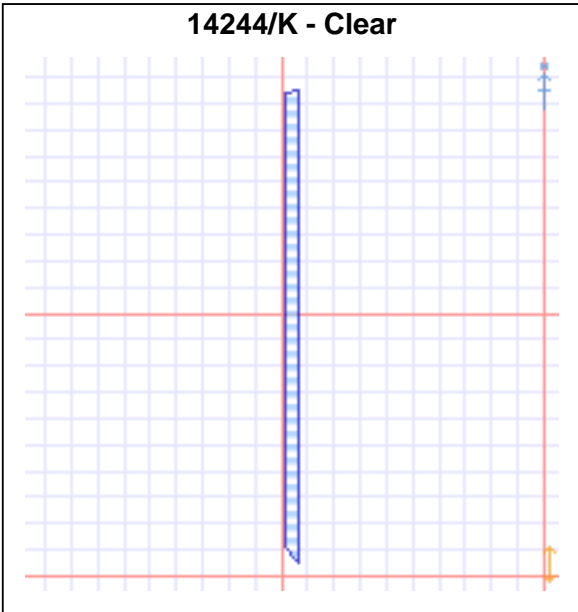

14244/L - Clear

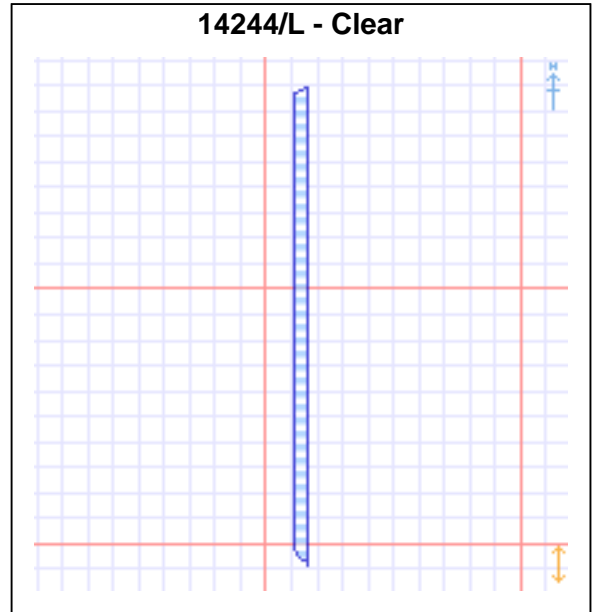

14244/M - Clear

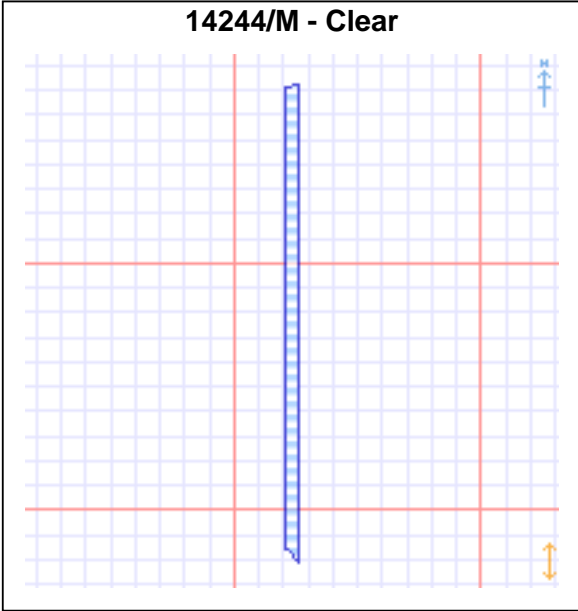

14244/N - Clear

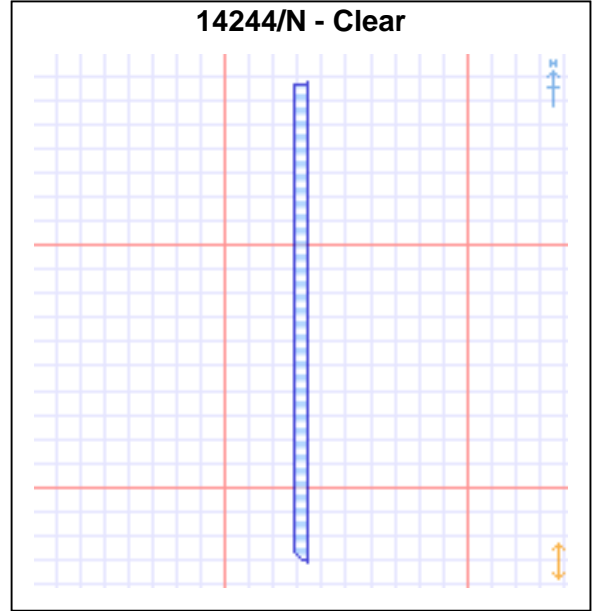

14244/O - Clear

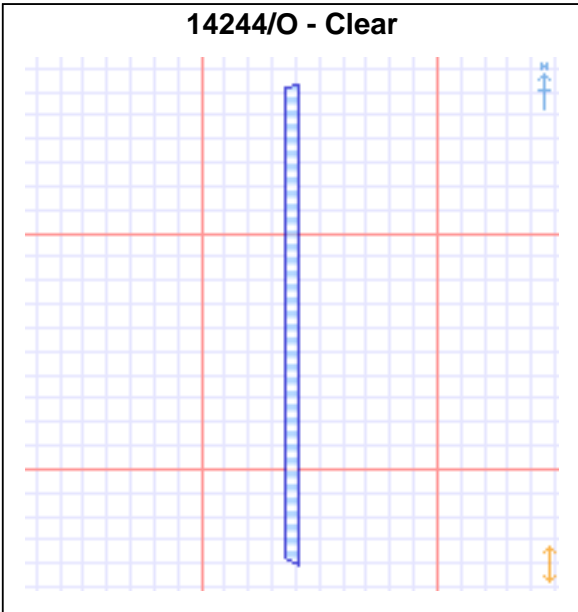

14244/P - Clear

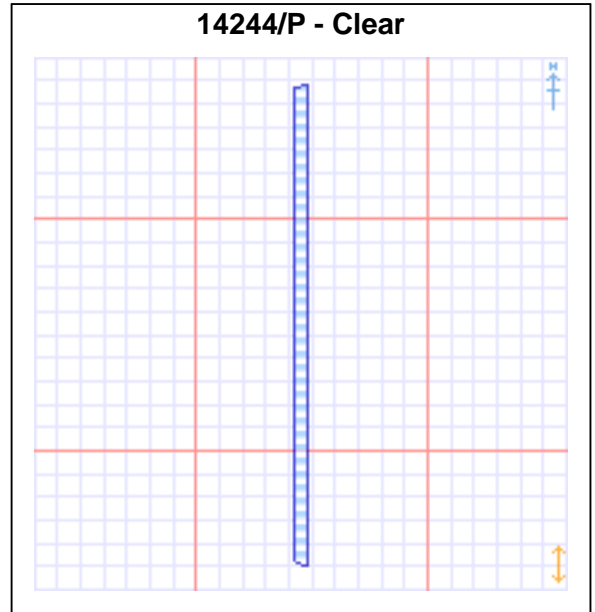

14244/Q - Clear

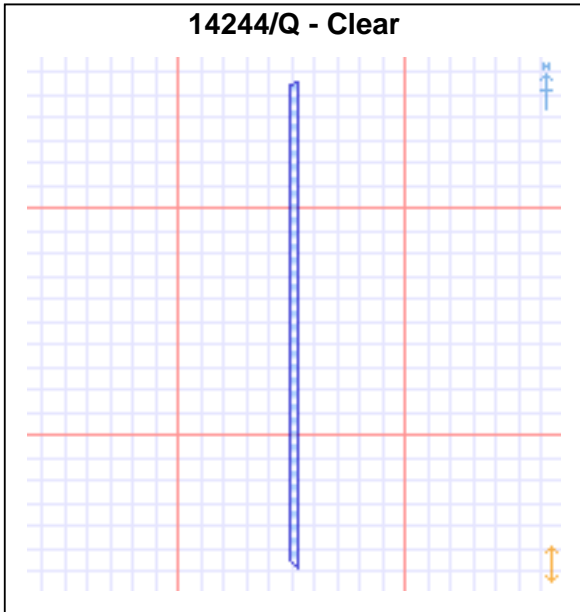

14244/R - Clear

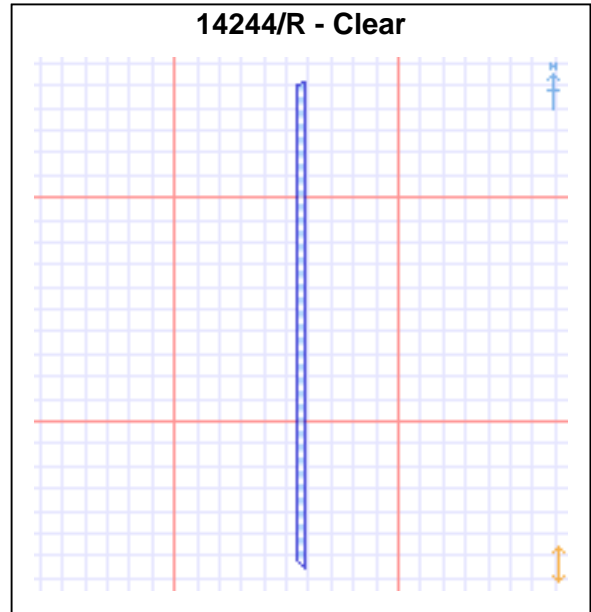

14244/S - Clear

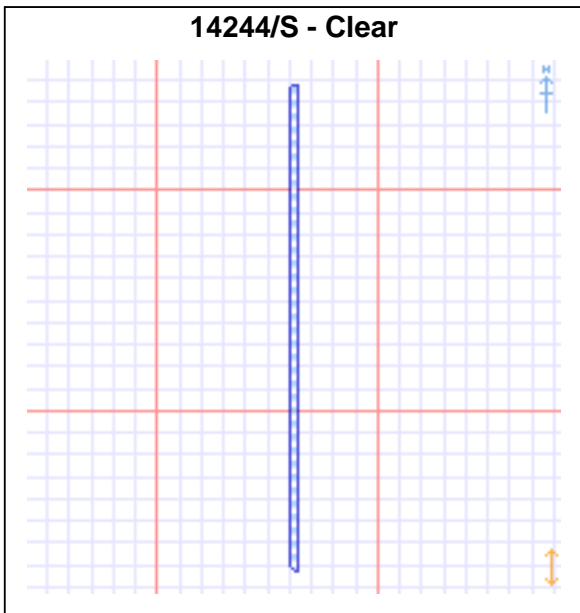

14244/T - Clear

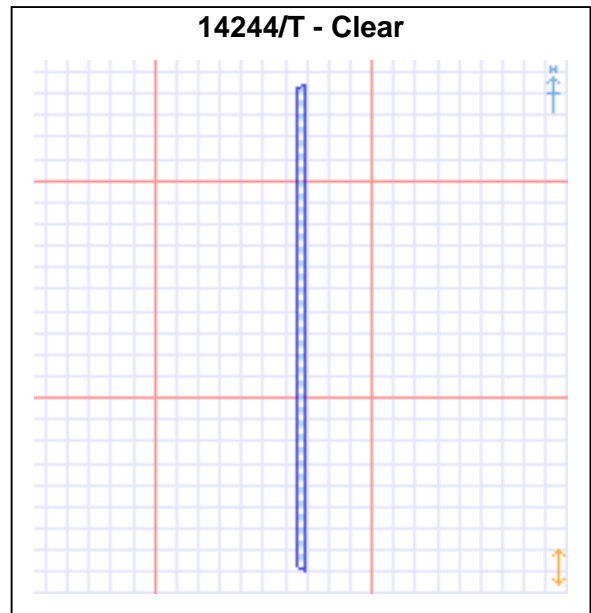

14244/U - Clear

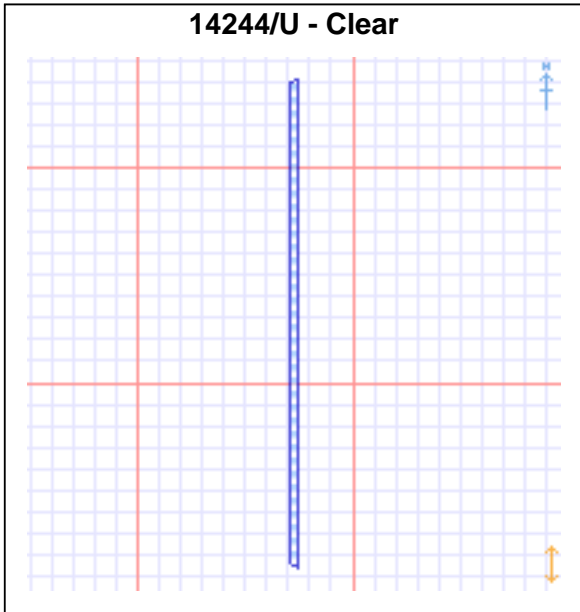

14244/V - Clear

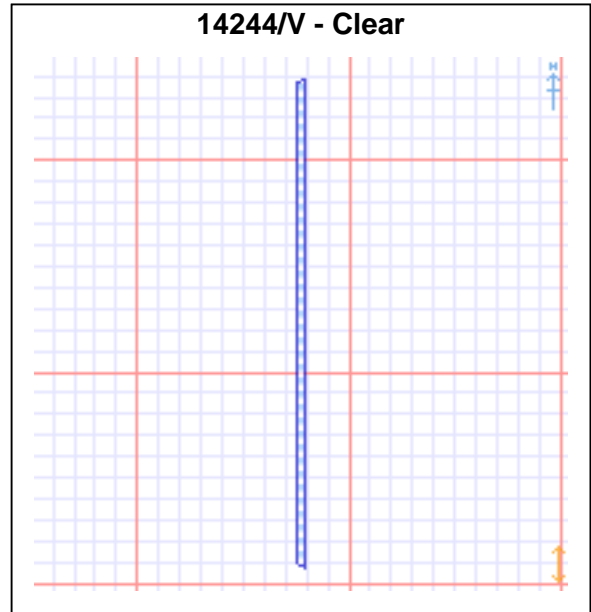

14244/W - Clear

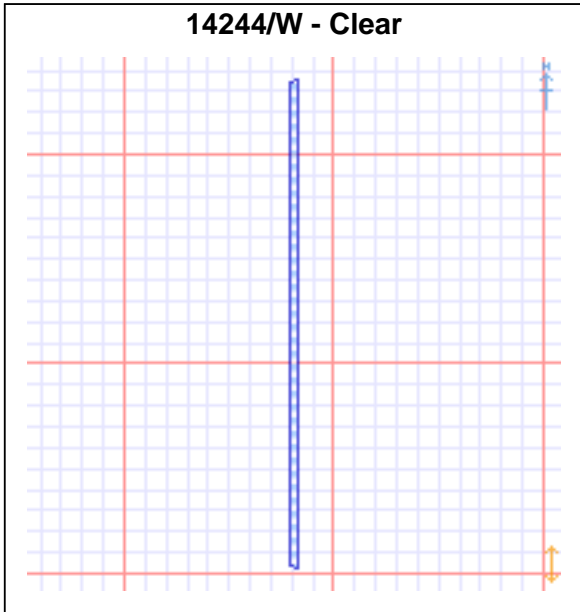

14244/X - Clear

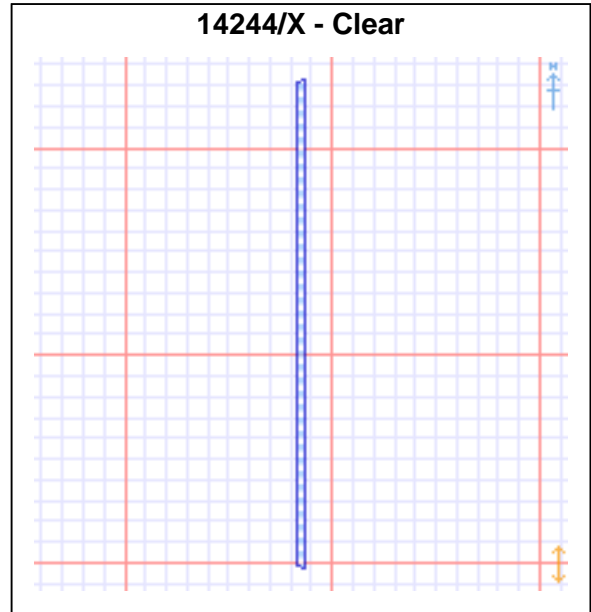

14244/Y - Clear

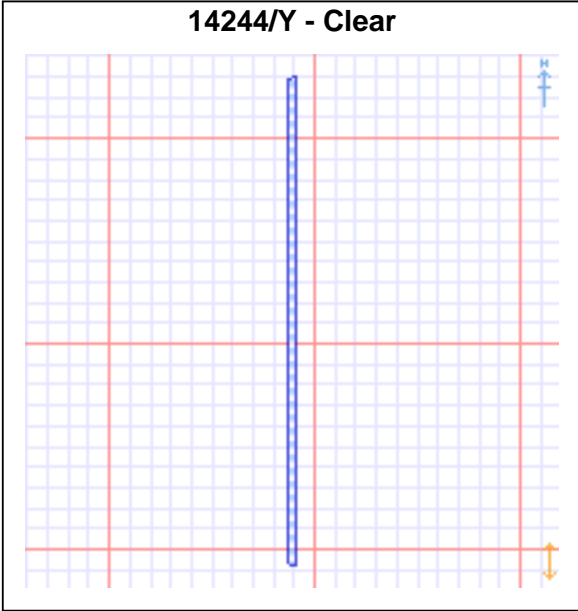

14244/Z - Clear

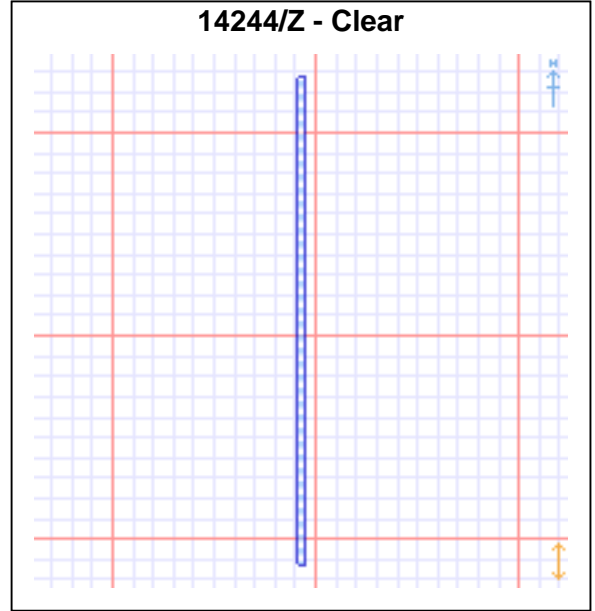

14244/[- Clear

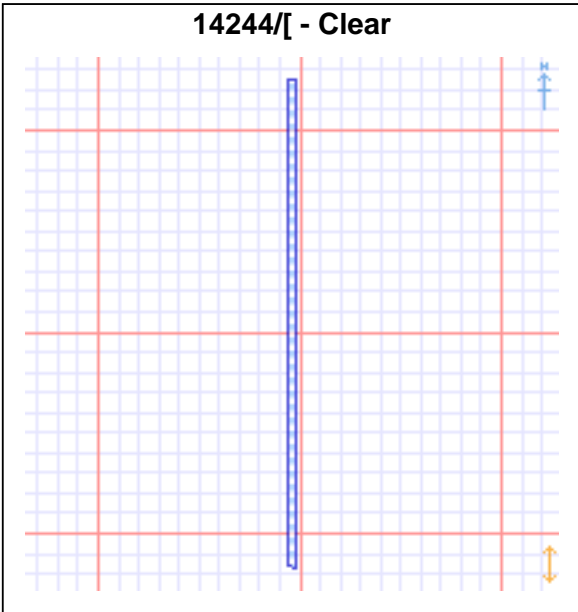

SASA
Roddinglaw Road
Edinburgh
EH12 9FJ

4th July 2017

Dear Sir/Madam,

SOIL TESTING FOR POTATO CYST NEMATODE (PCN)

FARM: WEST HERMISTON

CODE NO: 560/0025

FID NO: NT/16072/70416

Following an application of 21st June 2017, an official soil test for PCN conducted in accordance with paragraphs 1 to 6 of Schedule 15 of the Plant Health (Scotland) Order 2005 as amended by the Plant Health (Scotland) Amendment Order 2010 has been carried out on the sampled units requested on the above field. The results are set out below and the units sampled shown on the map overleaf. These results override any previously issued notices for the units sampled.

Sampled Unit	Area	Date of sampling	Result	<i>Globodera pallida</i>		<i>Globodera rostochiensis</i>	
				Infestation	Intensity	Infestation	Intensity
14245/A	0.1 Ha	23/06/2017	Clear	None	None	None	None
14245/B	0.1 Ha	23/06/2017	Clear	None	None	None	None
14245/C	0.1 Ha	23/06/2017	Clear	None	None	None	None
14245/D	0.1 Ha	23/06/2017	Clear	None	None	None	None
14245/E	0.1 Ha	23/06/2017	Clear	None	None	None	None
14245/F	0.1 Ha	23/06/2017	Clear	None	None	None	None
14245/G	0.1 Ha	23/06/2017	Clear	None	None	None	None
14245/H	0.1 Ha	23/06/2017	Clear	None	None	None	None
14245/I	0.1 Ha	23/06/2017	Clear	None	None	None	None
14245/J	0.1 Ha	23/06/2017	Clear	None	None	None	None
14245/K	0.1 Ha	23/06/2017	Clear	None	None	None	None
14245/L	0.1 Ha	23/06/2017	Clear	None	None	None	None
14245/M	0.1 Ha	23/06/2017	Clear	None	None	None	None
14245/N	0.1 Ha	23/06/2017	Clear	None	None	None	None
14245/O	0.1 Ha	23/06/2017	Clear	None	None	None	None
14245/P	0.1 Ha	23/06/2017	Clear	None	None	None	None
14245/Q	0.1 Ha	23/06/2017	Clear	None	None	None	None
14245/R	0.1 Ha	23/06/2017	Clear	None	None	None	None
14245/S	0.1 Ha	23/06/2017	Clear	None	None	None	None
14245/T	0.1 Ha	23/06/2017	Clear	None	None	None	None
14245/U	0.1 Ha	23/06/2017	Clear	None	None	None	None
14245/V	0.1 Ha	23/06/2017	Clear	None	None	None	None
14245/W	0.1 Ha	23/06/2017	Clear	None	None	None	None
14245/X	0.1 Ha	23/06/2017	Clear	None	None	None	None
14245/Y	0.1 Ha	23/06/2017	Clear	None	None	None	None
14245/Z	0.1 Ha	23/06/2017	Clear	None	None	None	None
14245/[0.1 Ha	23/06/2017	Clear	None	None	None	None

CLEARANCE FOR SEED POTATO PRODUCTION (INCLUDING FARM SAVED SEED)

VALID FOR SEASONS 2017 TO 2020

VALID FOR PB PRODUCTION 2017 TO 2020

For sampled units marked "Clear" in the table above, no viable PCN (*Globodera rostochiensis* or *Globodera pallida*) were found in the soil taken from that unit.

IMPORTANT

1. This clearance is valid for the period shown above, or until potatoes are planted in the land, whichever is earlier.
2. If produce from the specified sampled units is to be exported, the importing country may have special requirements in relation to PCN which are not met by this clearance.
3. This clearance may be withdrawn by SASA at any time if PCN are found in the sampled unit or

in soil or plant material connected with the sampled unit.

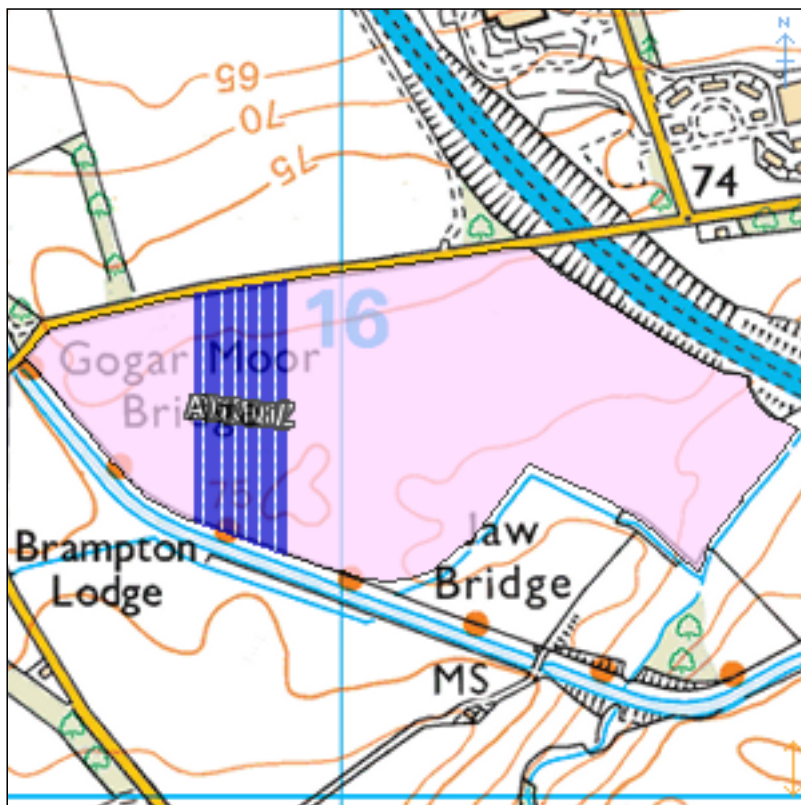

 Clear
 Infested

Soil Test: 14245

OS Base Layer reproduced by permission of Ordnance Survey on behalf of HMSO. © Crown copyright and database right 2017. All rights reserved. Ordnance Survey Licence number 100024655. © Crown copyright. All rights reserved Scottish Government 2017.

Please find maps with measurements for each individual sample unit appended to the end of this notification.

If you have any questions about these results, please contact me using the contact details given below.

Yours faithfully

SPCS Administration

T: 0131 244 8963

F: 0131 244 8920

E: @sasa.gsi.gov.uk

Sample Units (major grid: 100m, minor grid: 10m)

14245/A - Clear

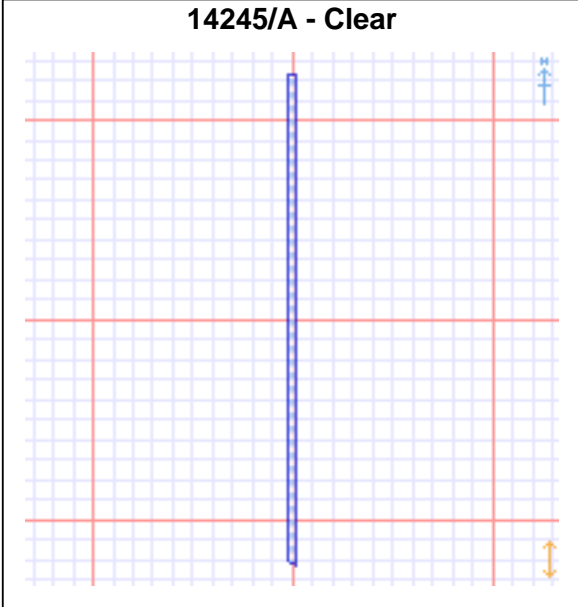

14245/B - Clear

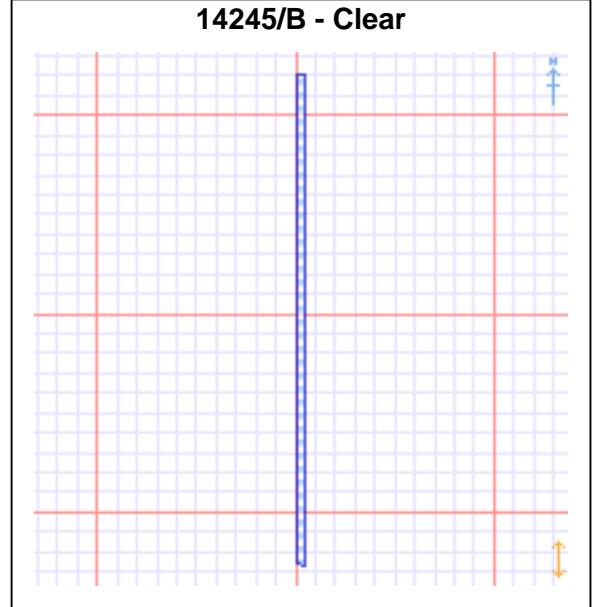

14245/C - Clear

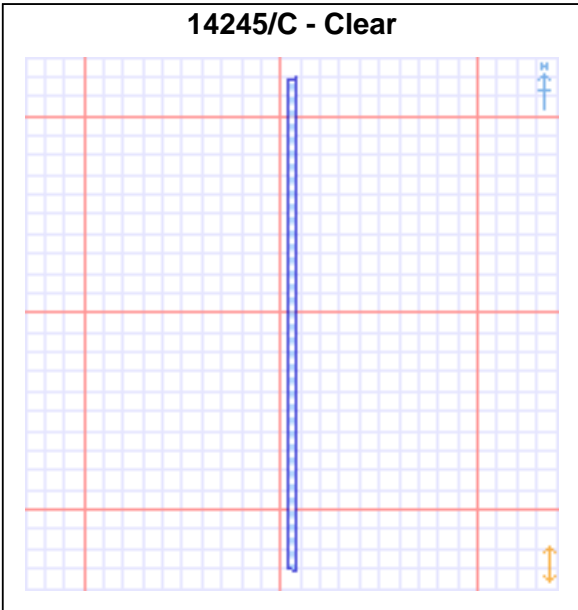

14245/D - Clear

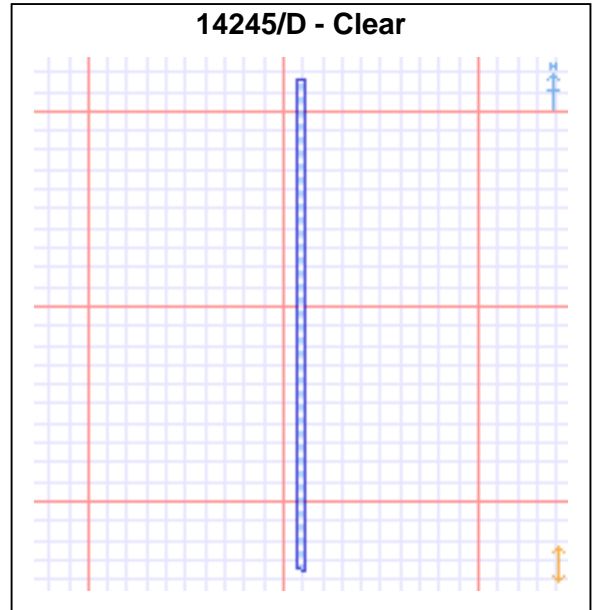

14245/E - Clear

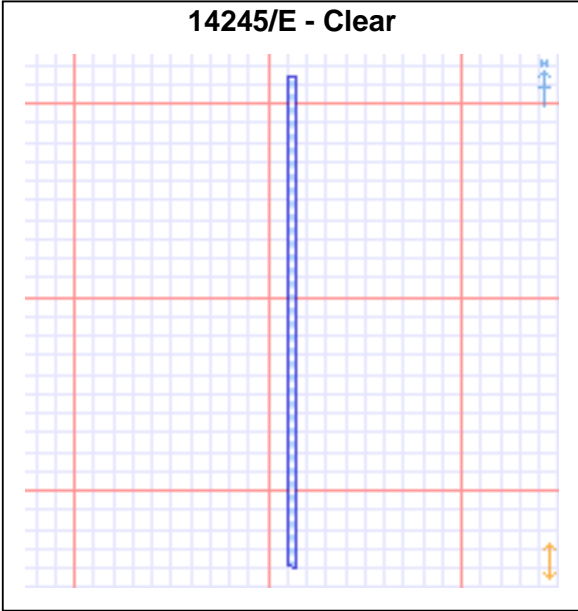

14245/F - Clear

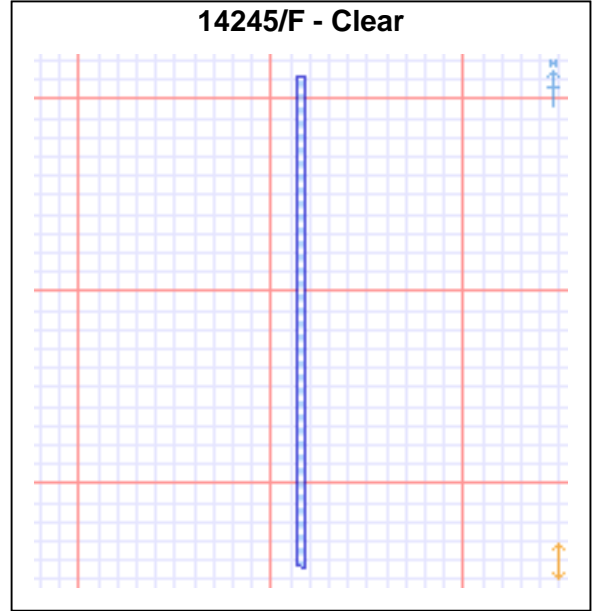

14245/G - Clear

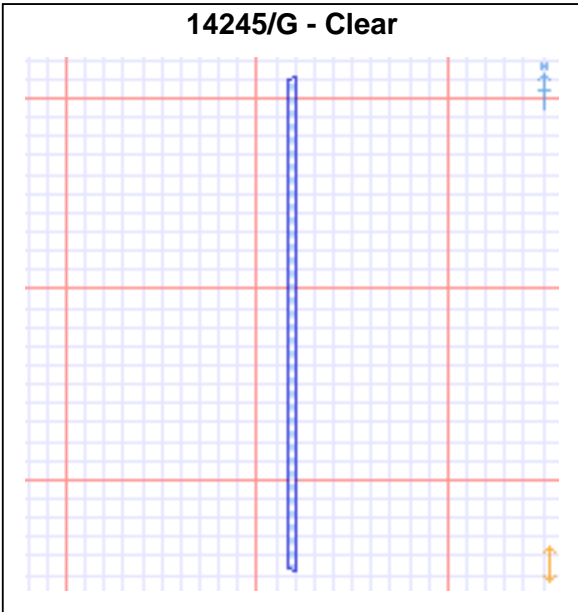

14245/H - Clear

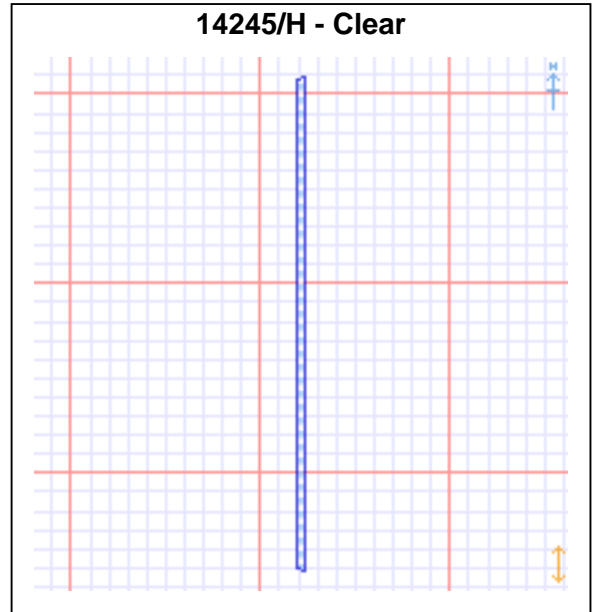

14245/I - Clear

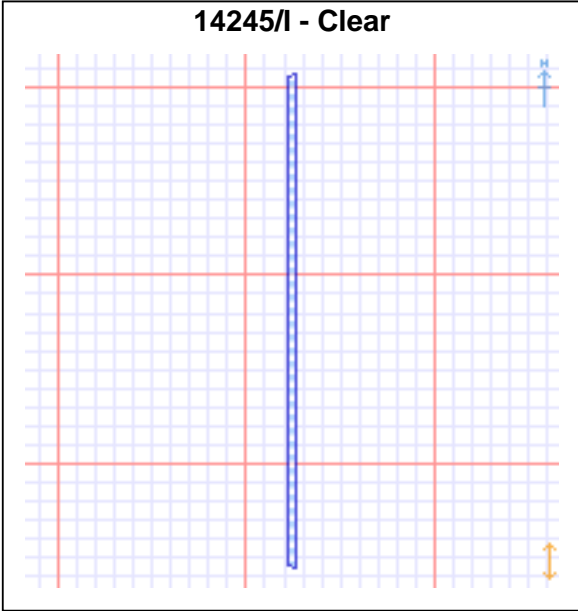

14245/J - Clear

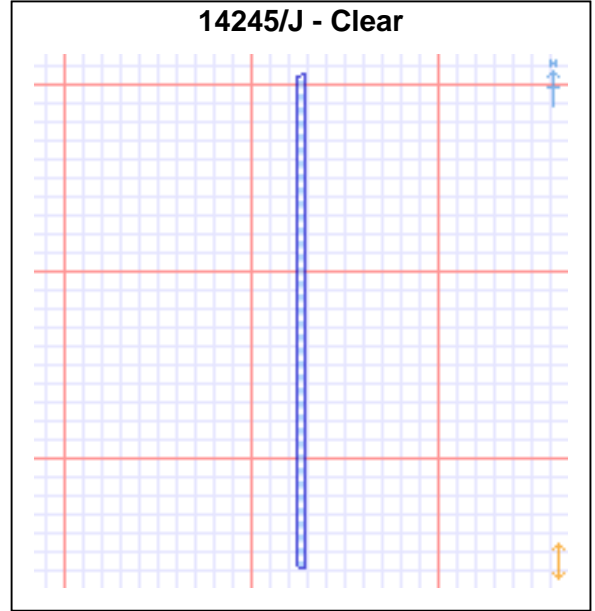

14245/K - Clear

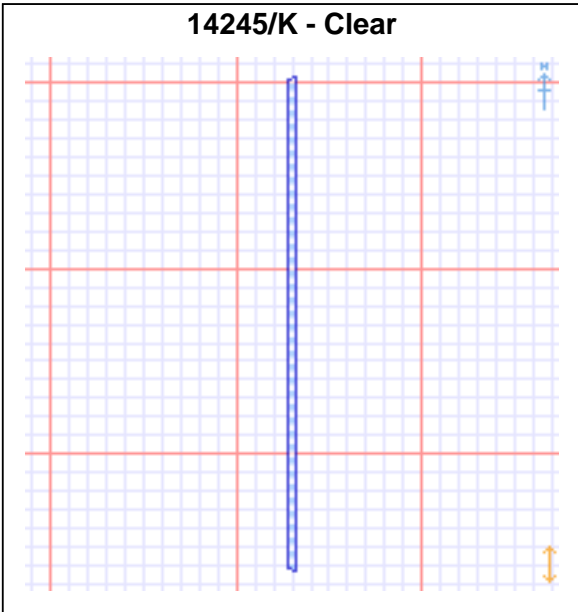

14245/L - Clear

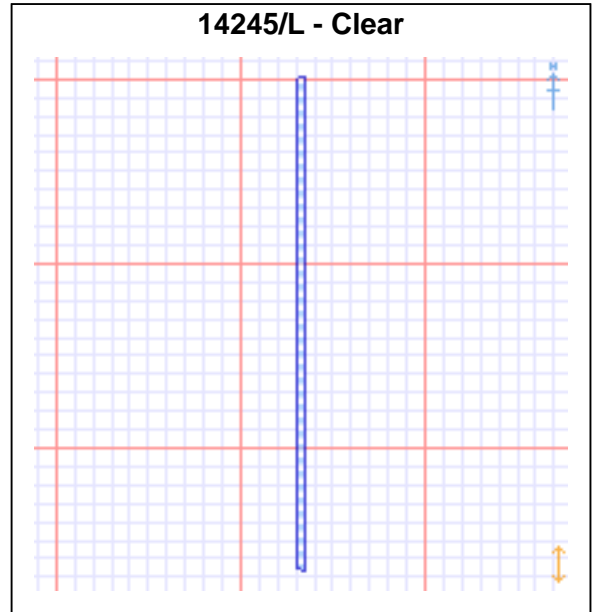

14245/M - Clear

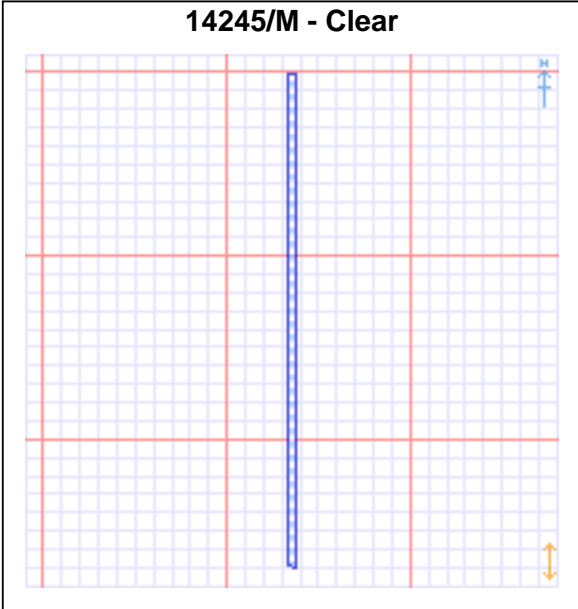

14245/N - Clear

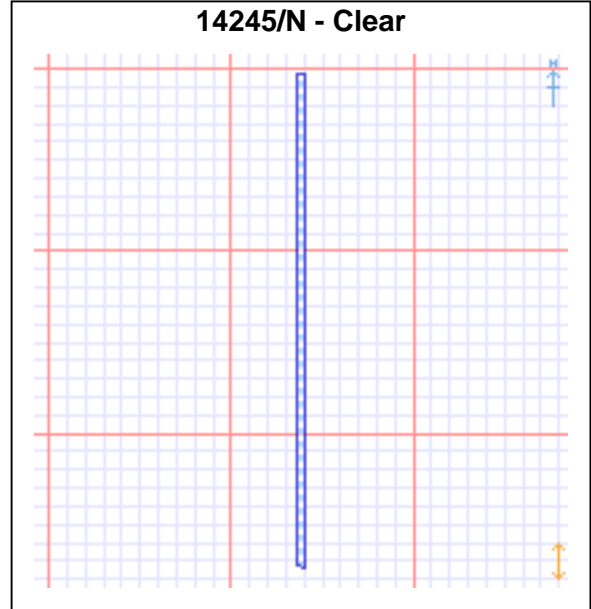

14245/O - Clear

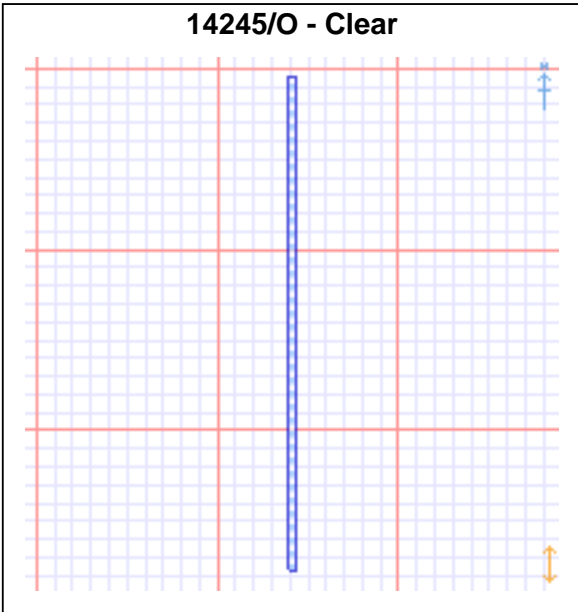

14245/P - Clear

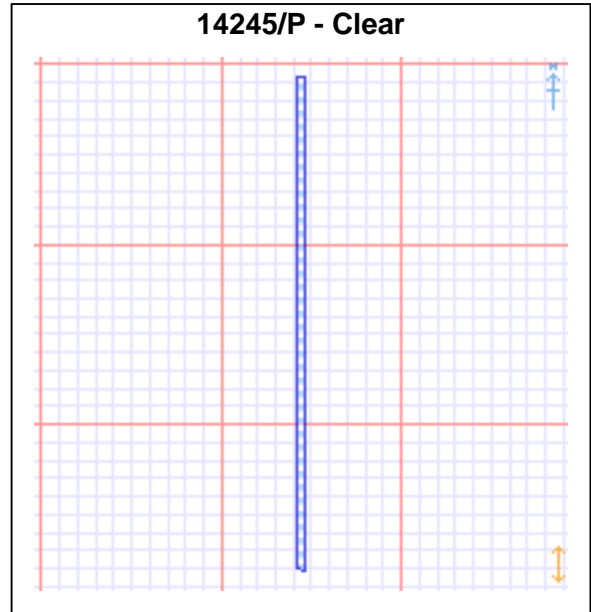

14245/Q - Clear

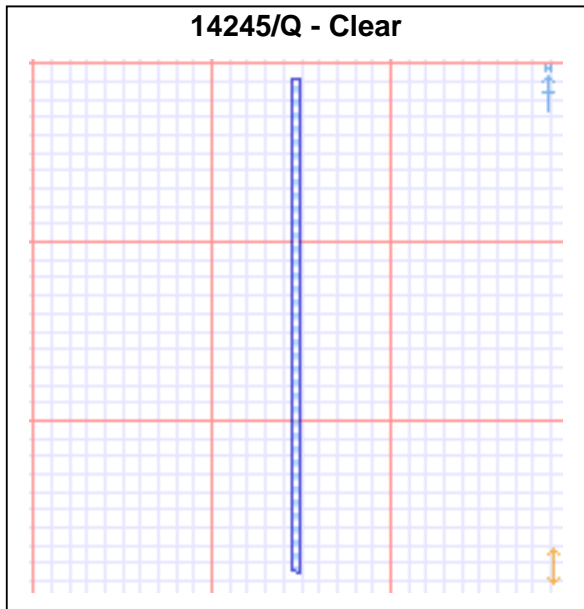

14245/R - Clear

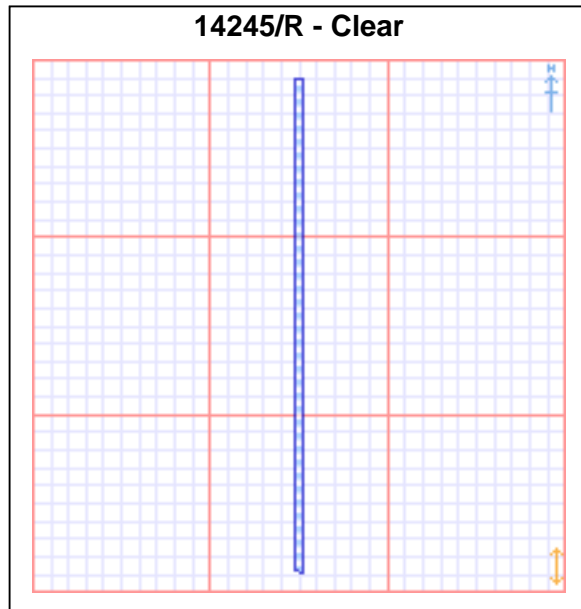

14245/S - Clear

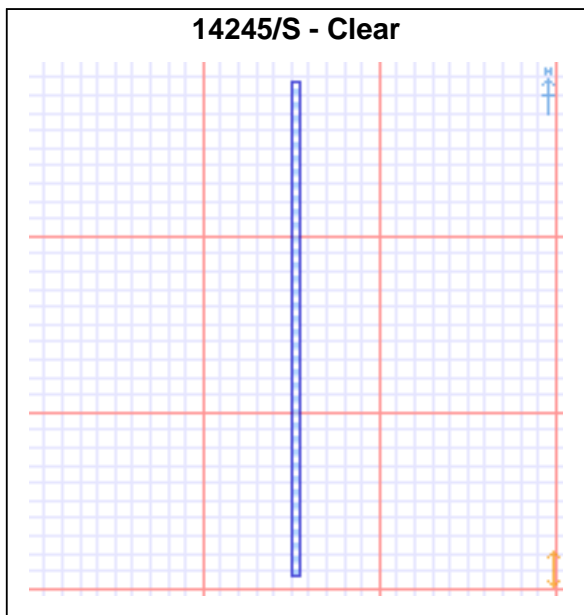

14245/T - Clear

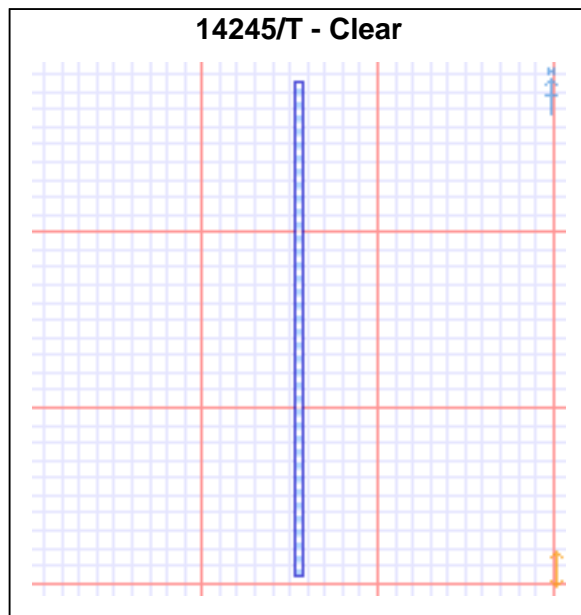

14245/U - Clear

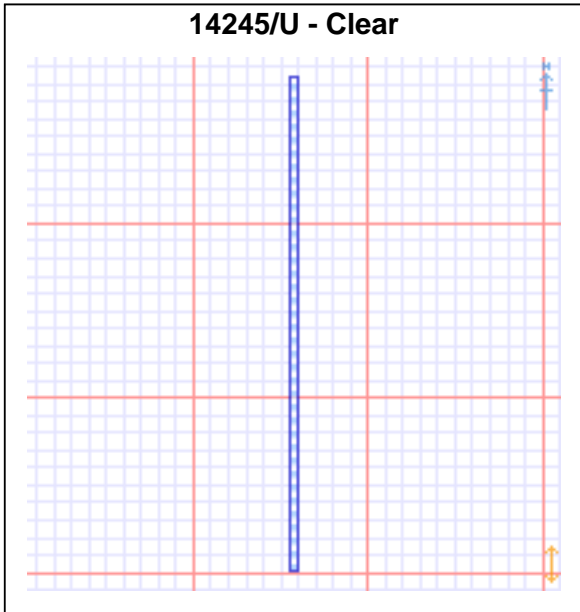

14245/V - Clear

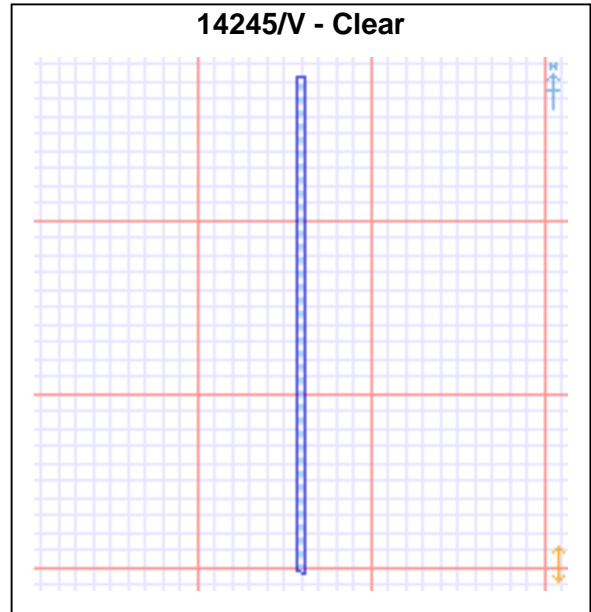

14245/W - Clear

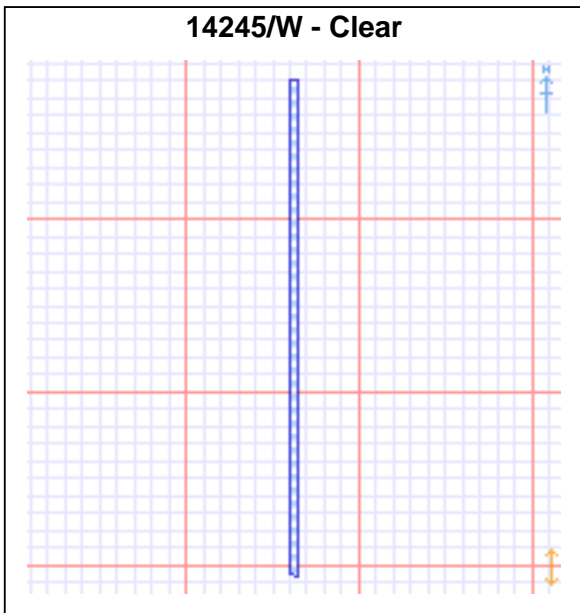

14245/X - Clear

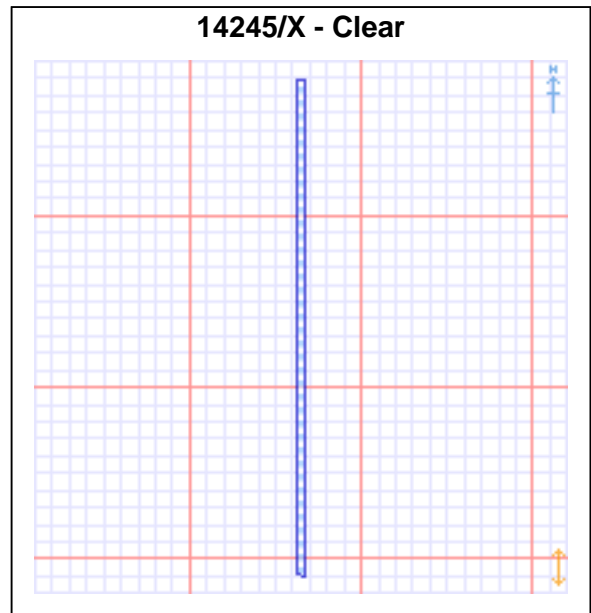

14245/Y - Clear

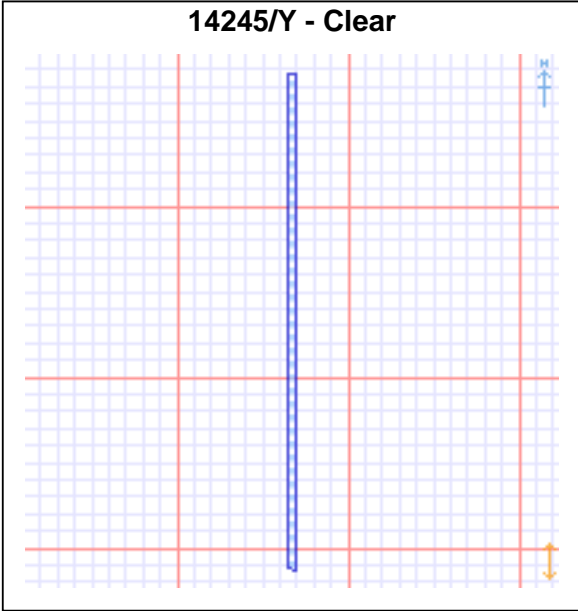

14245/Z - Clear

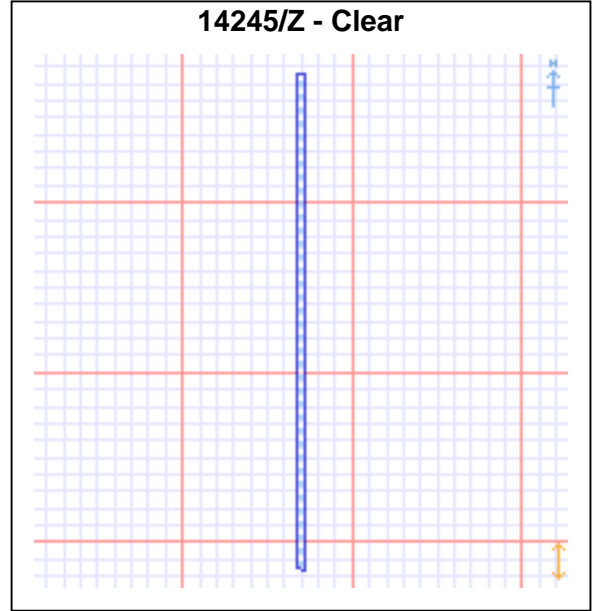

14245/[- Clear

